

# PT SERIES

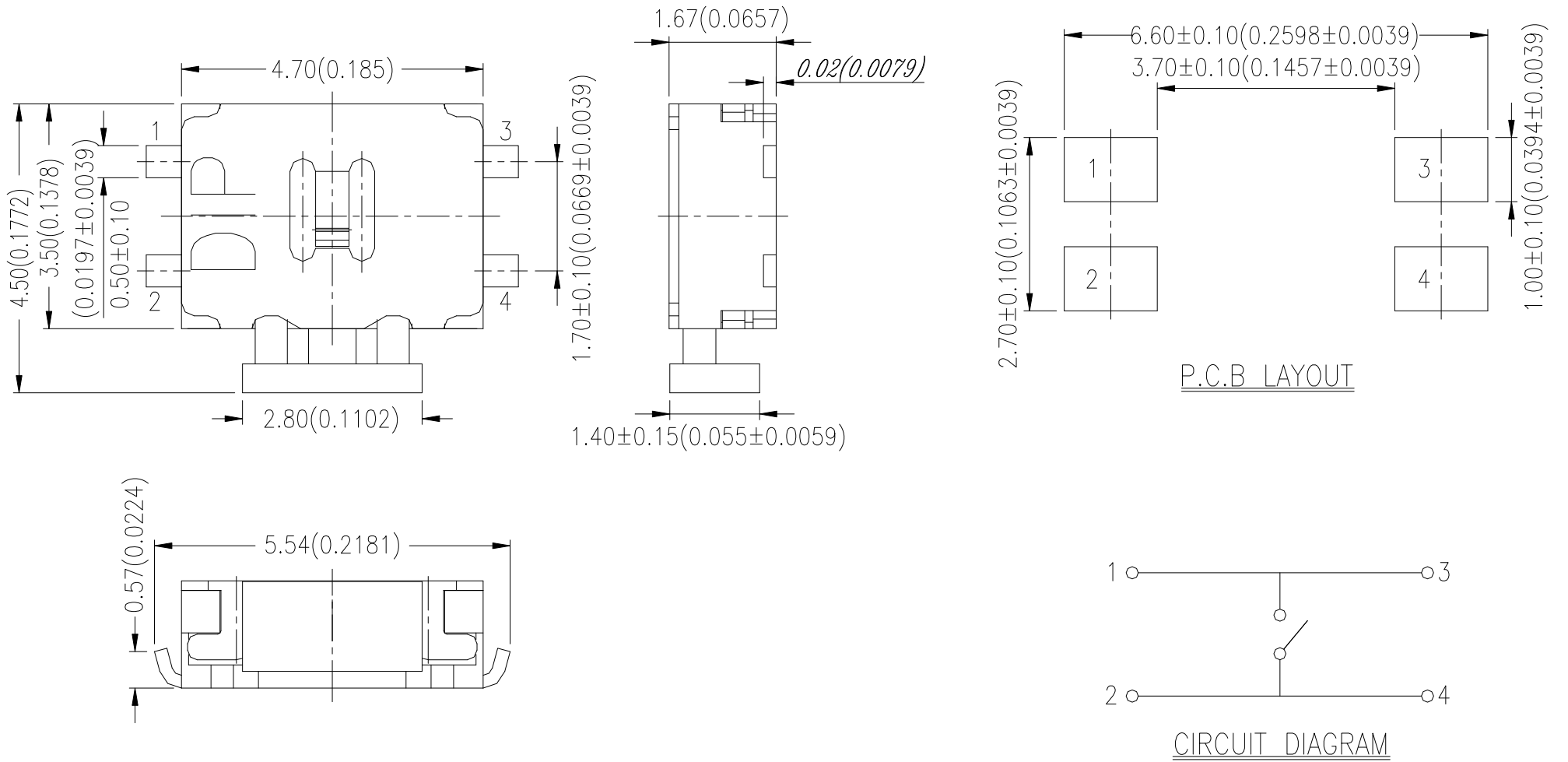

## DIMENSIONS

PTL



GENERAL TOLERANCES MAX: ±0.2mm.

PTCL

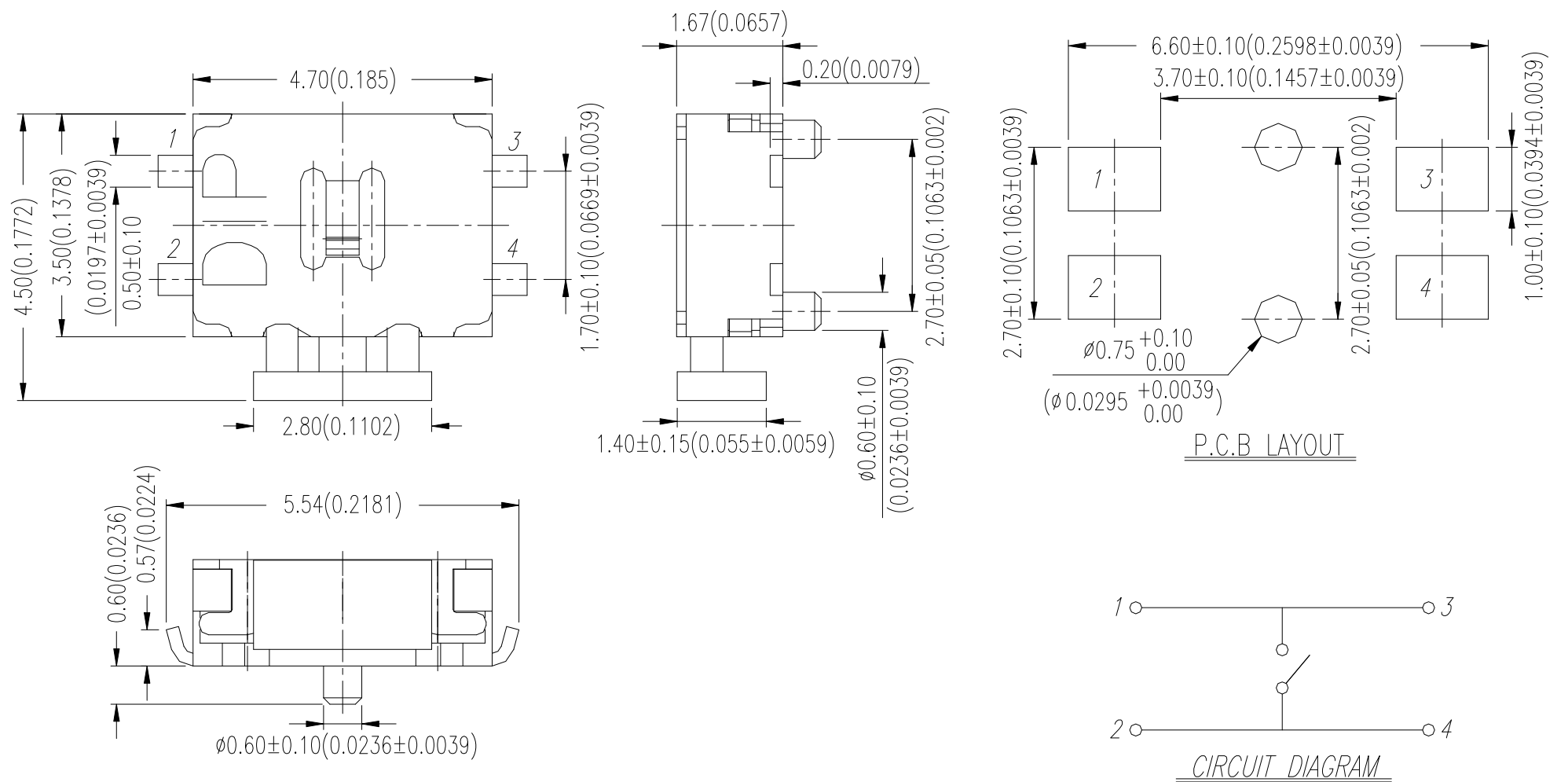

GENERAL TOLERANCES MAX: ±0.2mm.

**PTCLGP**

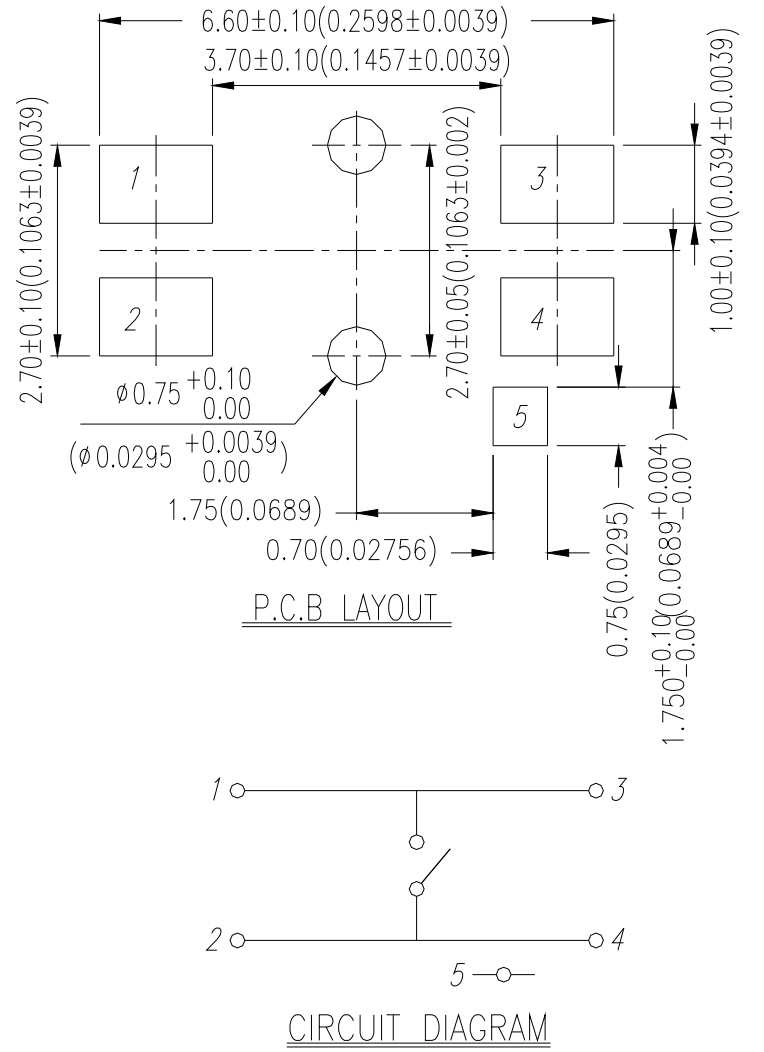
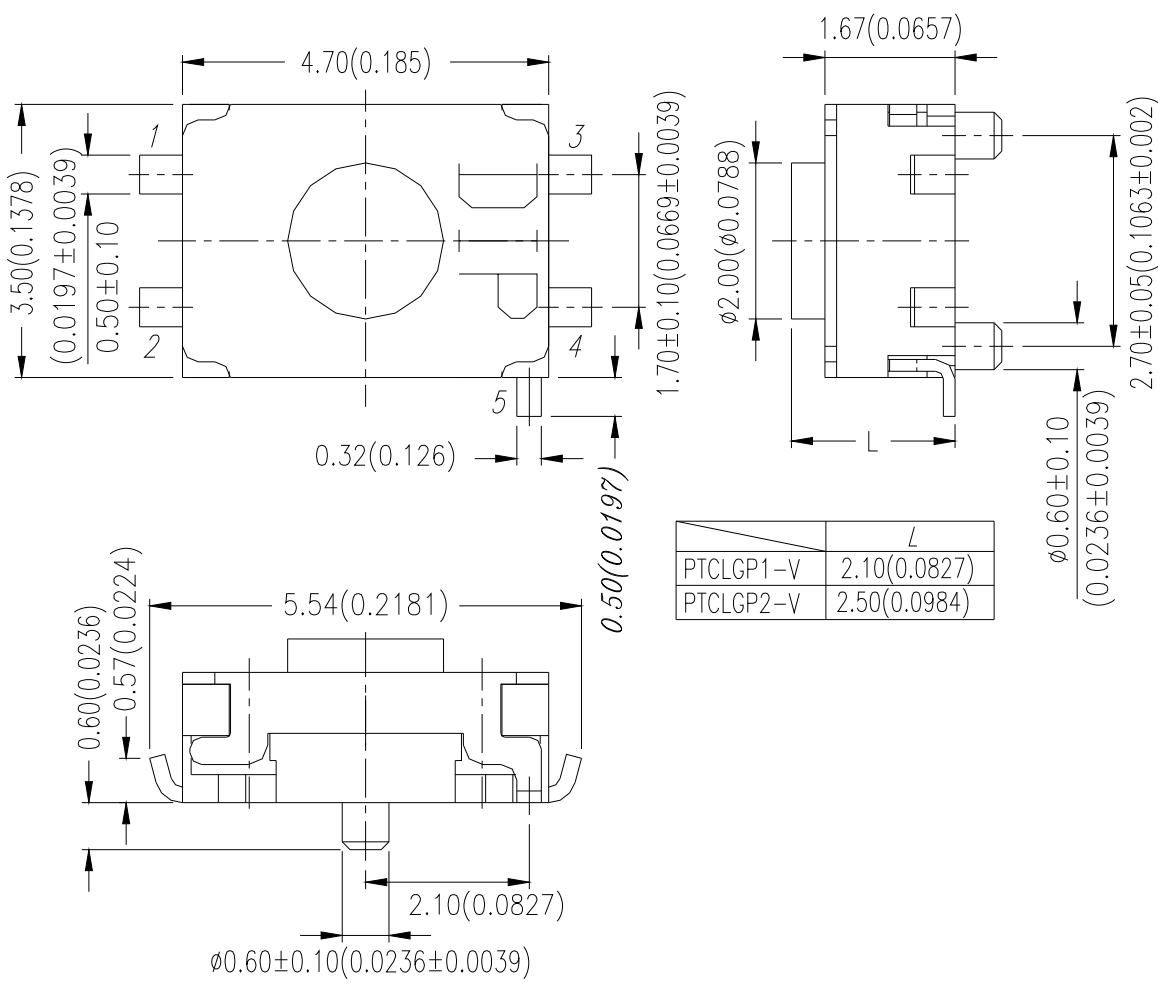

**GENERAL TOLERANCES MAX:±0.2mm.**

**PTF**

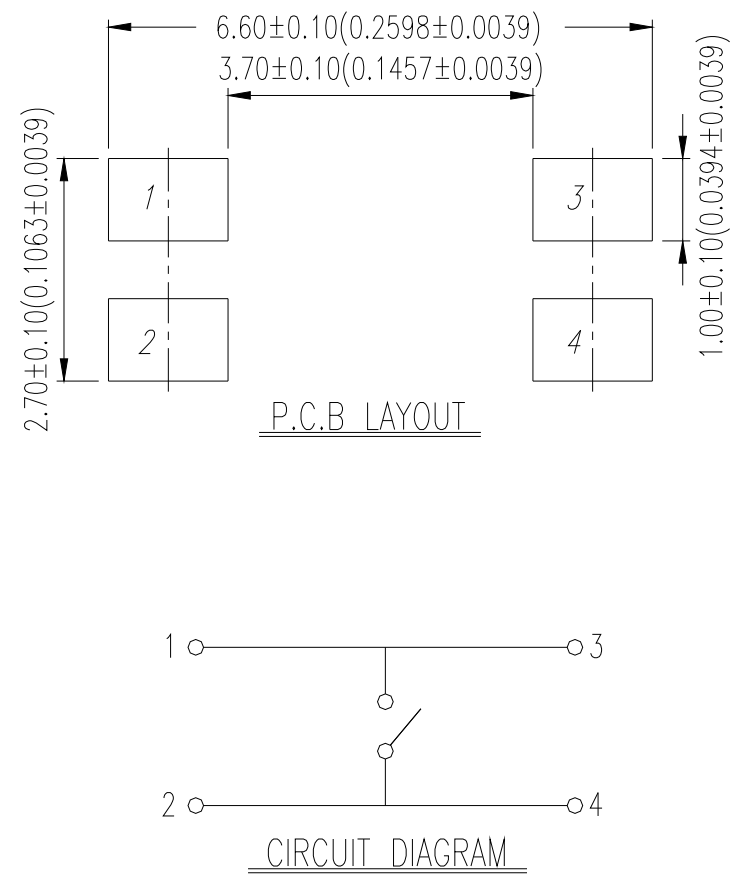
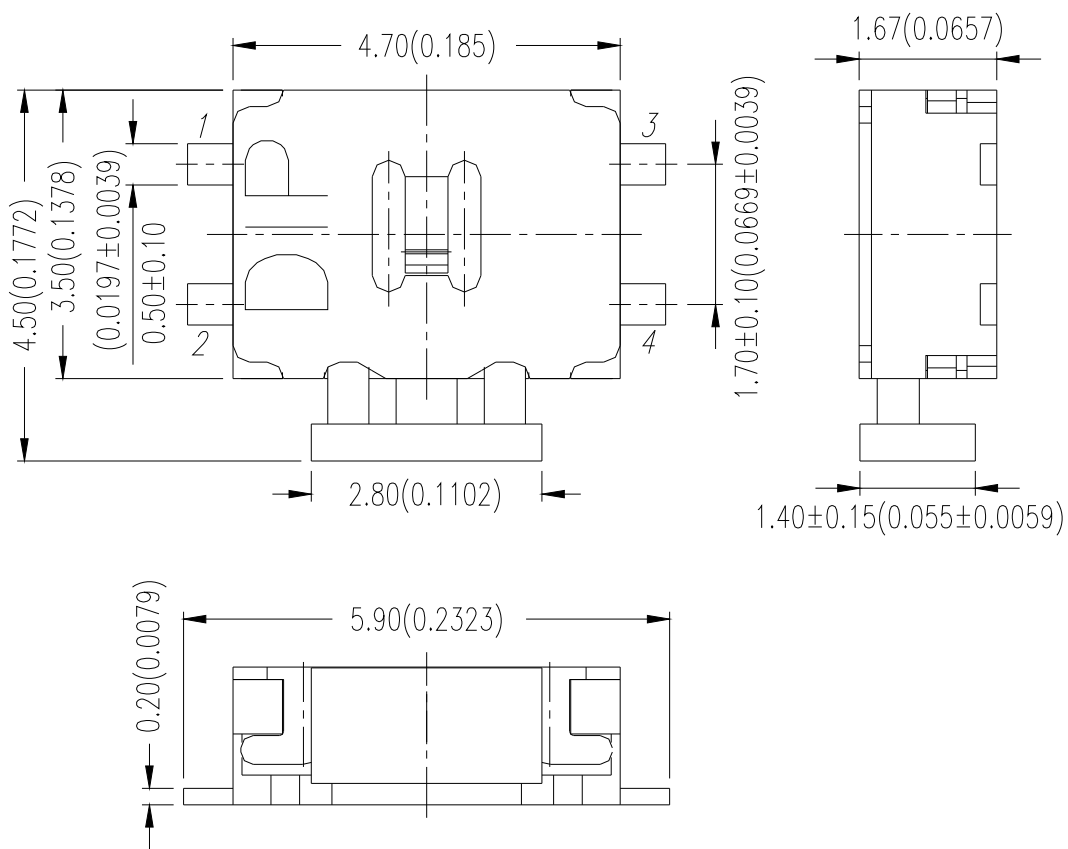

**GENERAL TOLERANCES MAX:±0.2mm.**

**PTCF**

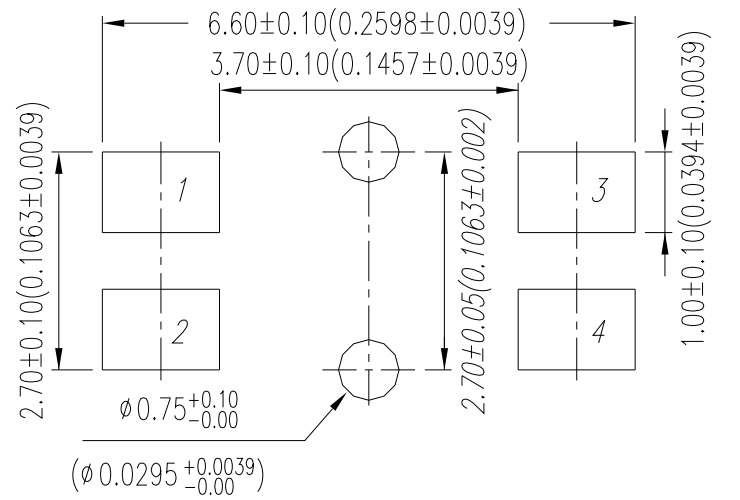
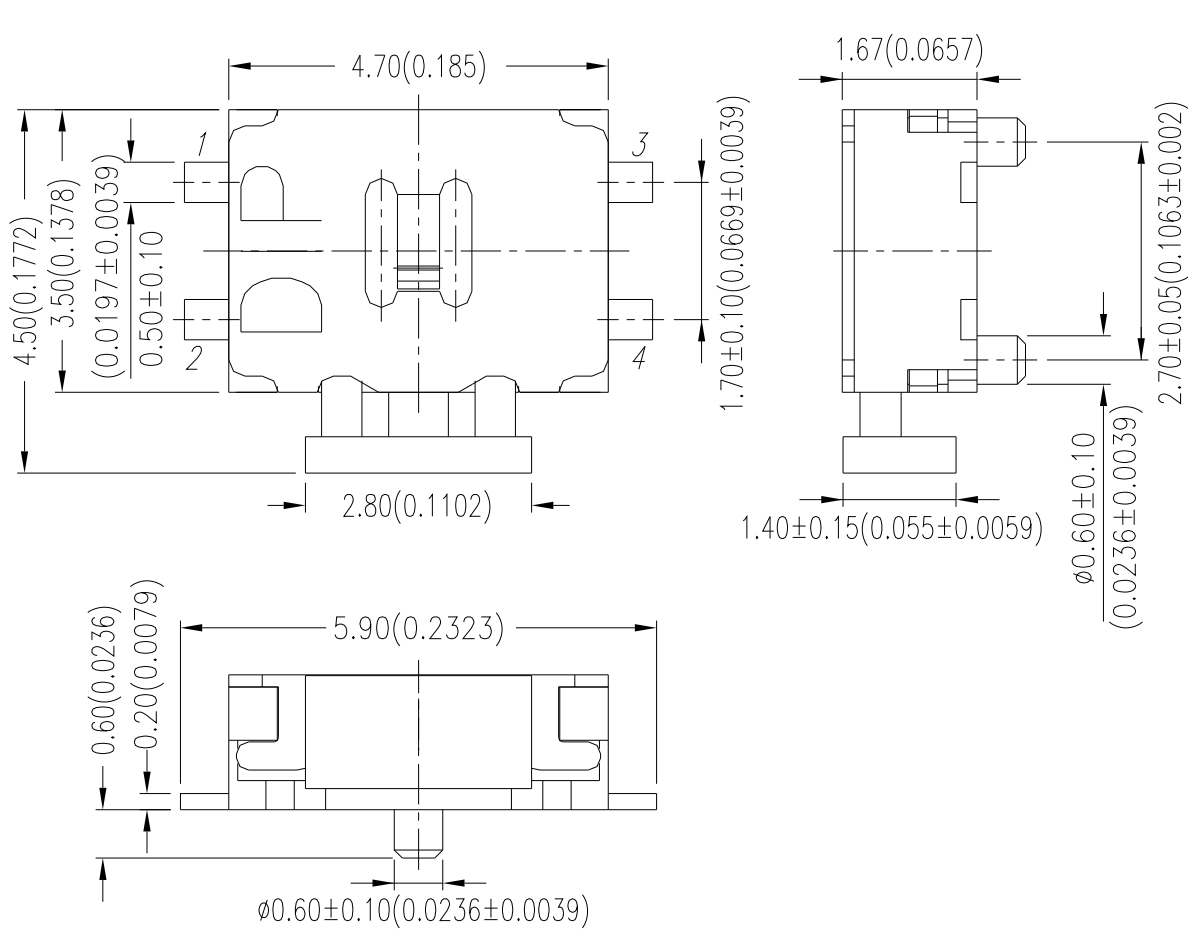

P.C.B. LAYOUT

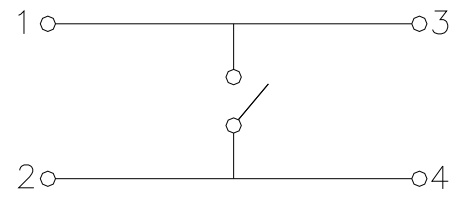

CIRCUIT DIAGRAM

**GENERAL TOLERANCES MAX:±0.2mm.**

**PTCFG**

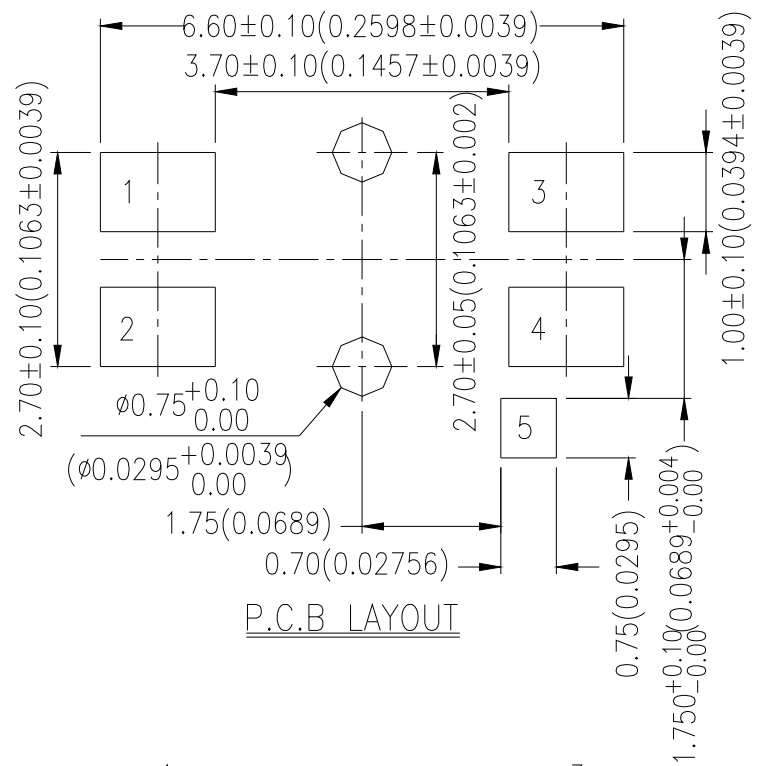
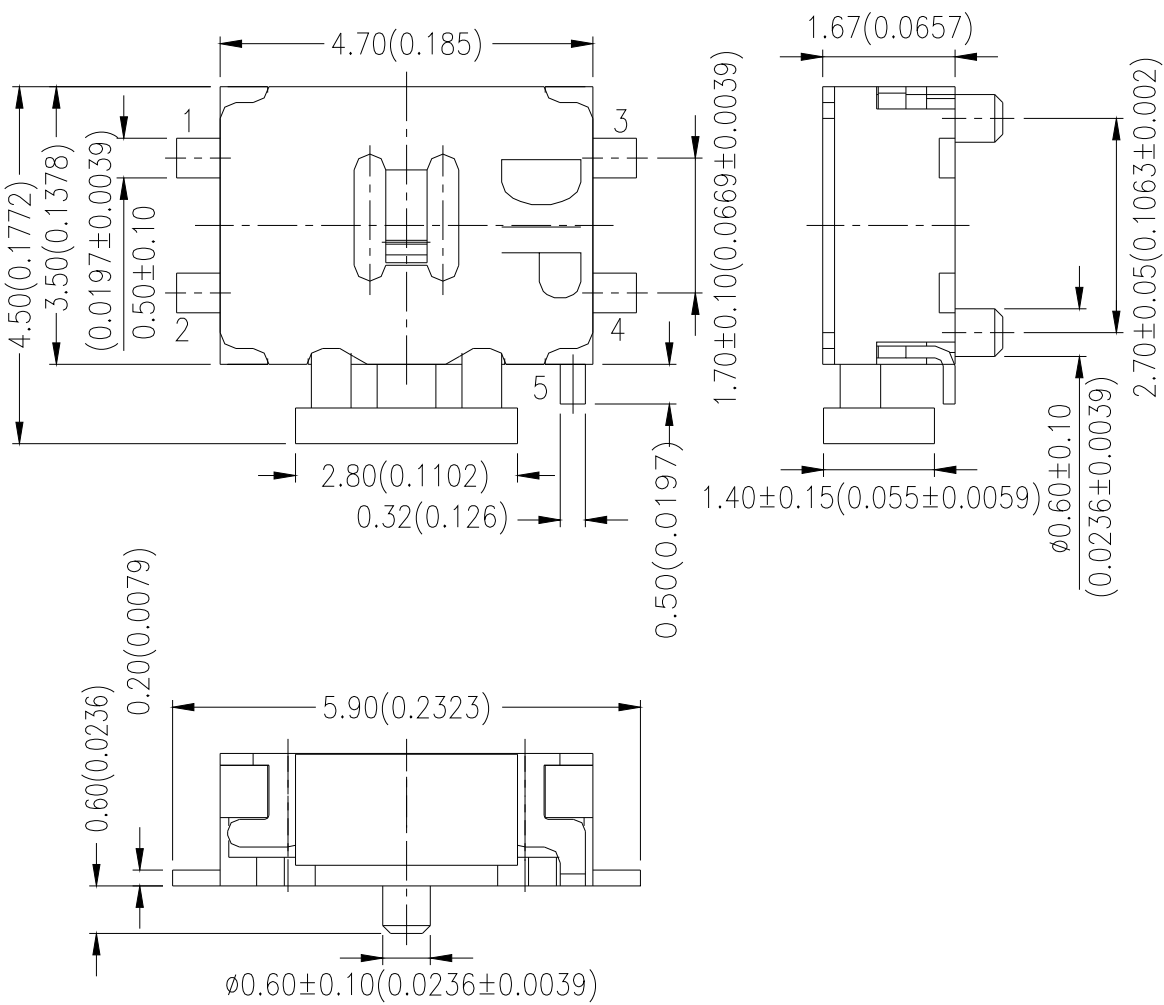

P.C.B. LAYOUT

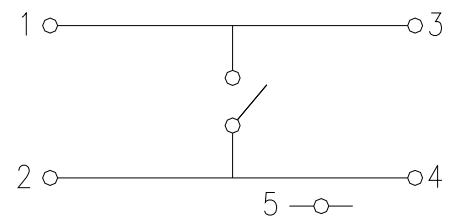

CIRCUIT DIAGRAM

**GENERAL TOLERANCES MAX:±0.2mm.**

## HOW TO ORDER

PT     -  -

Package Style :  
T/R = Tape & Reel

Soldering :  
V = Lead Free Solderable  
Q = Halogen Free

Stem Height For Vertical Push Type :  
 = Side Push  
P1 = Vertical Push H:2.1mm  
P2 = Vertical Push H:2.5mm

= Without Ground Terminal  
G = With Ground Terminal

Terminal Type :  
L = With L S.M.T Terminal  
F = With F S.M.T Terminal

= Without Post  
C = With Post

Side/Vertical Push Switch

## SPECIFICATION

### △MECHANICAL

Operation Force:

220 +80/-70gf Side push

160 ± 50gf Vertical push

Stroke: 0.30 <sup>+0.10 mm</sup> <sub>-0.15 mm</sub> Side push

0.20 ± 0.1 mm Vertical push

Operation Temperature: -25°C to +70°C

Storage Temperature: -30°C to +80°C

### △ELECTRICAL

Electrical Life: 100,000 cycles min. for PT(C)L, PT(C)F

Rating: 50mA, 12VDC

Contact Resistance: 100mΩ max.

Insulation Resistance: 100MΩ min. 500VDC

Dielectric Strength: 250VAC/ 1minute

Contact Arrangement: 1 pole 1 throw

## MATERIAL

△COVER: Stainless Steel

△CONTACT DISC: Stainless steel

△TERMINAL: Brass with silver plated

△BASE: UL 94V-0 High-temp. thermoplastic

Color: Black

△STEM: UL 94V-0 High-temp. thermoplastic

Color: Black

△TAPE: Teflon

## SOLDERING PROCESSES

△HAND SOLDERING : Use a soldering iron of 30 watts, controlled at 350°C approximately max 5 seconds.

△REFLOW SOLDERING : When applying reflow soldering , the peak temperature or the reflow over should be set to 260°C max.

△Reflow Temperature Profile:

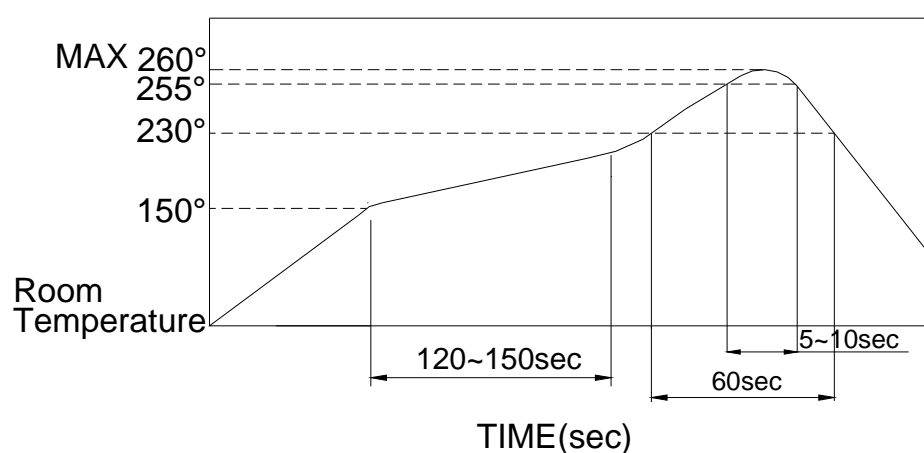

# PACKING

<b>Part Number</b>	<b>Number Per Reel</b>	
Side push type	3000	
Vertical push type	2400	

## PT(Side push type) REEL

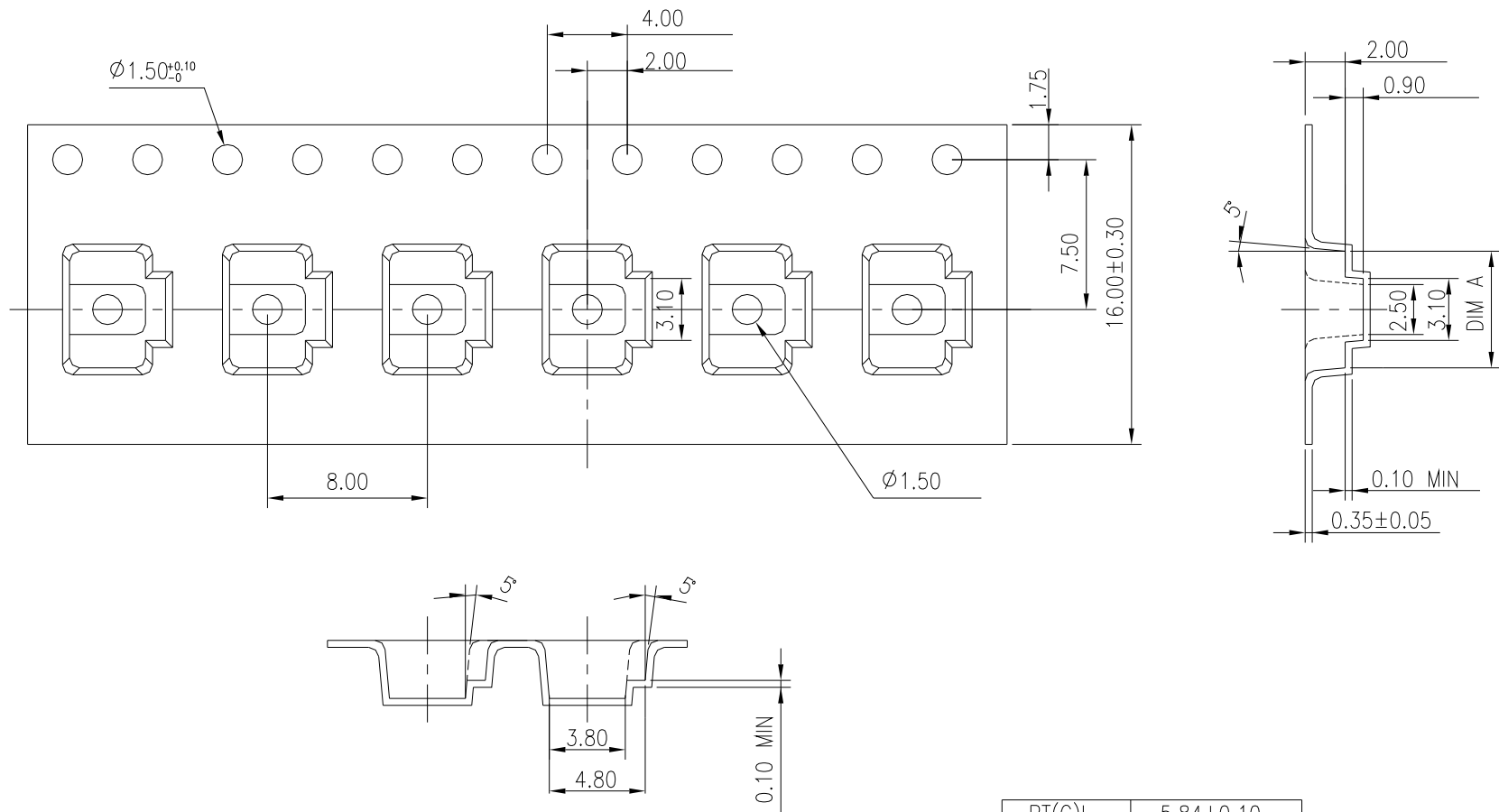

PT(C)L	5.84±0.10
PT(C)F	6.20±0.10
PAPT NAME	DIM A

General Tolerance : ±0.1mm

## PT(Vertical push type) REEL

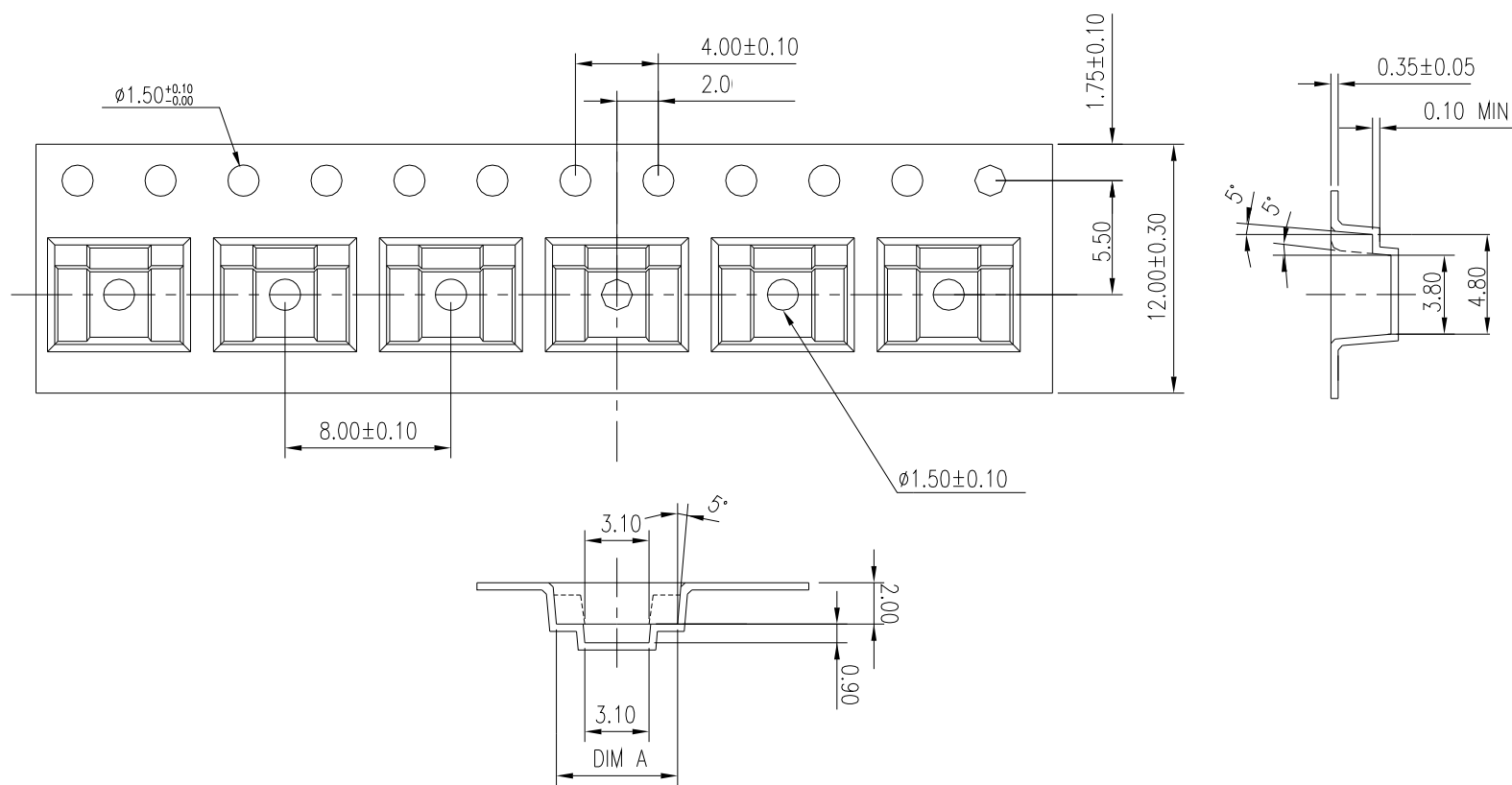

PT(C)L-N	5.84±0.10
PT(C)F-N	6.20±0.10
PAPT NAME	DIM A

General Tolerance : ±0.1mm